

ASTROS POD Utility User Manual

POD Utility

V1.0

Noemie Liu



Contents

1	ASTROS POD UTILITY INTRODUCTION	3
2	START USING ASTROS POD UTILITY	3
2.1	SETUP	3
2.2	CONFIGURATION	4
2.3	PAIR TO ASTROS STATION	5
2.4	CHECK ASTROS POD DETAILS	7
2.5	CLICK AND PAIR	9
3	POD UTILITY SOFTWARE SETTINGS & INFO	10
	CLICK THE SETTINGS ICON ON THE TOP RIGHT.	

1 ASTROS POD Utility Introduction

Pod Utility is a Windows-based application designed to provide users with convenient and efficient tools for configuring and managing ASTROS Pods. It simplifies setup and enhances user experience with easy-to-use features.

Key Functions of Pod Utility

- **Firmware Update:** Allows users to update ASTROS POD Firmware.
- **Device Pairing:** Supports pairing the ASTROS Pod with an ASTROS Station through POD Utility software.

2 Start using ASTROS POD Utility

2.1 Setup

What you will need:

- A PC with POD Utility installed
Download the software – [Pod Utility](#) and install
- ASTROS POD
- ASTROS station IP or a wireless AP SSID
(refer to POD pairing)

What you will need to do:

Open POD Utility on the PC > Connect to ASTROS POD
You will then see the LED on POD blinking green while the setup.

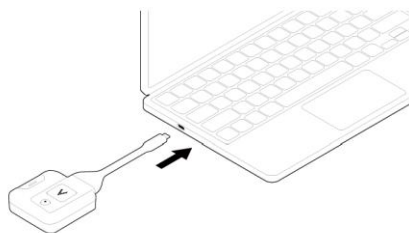

2.2 Configuration

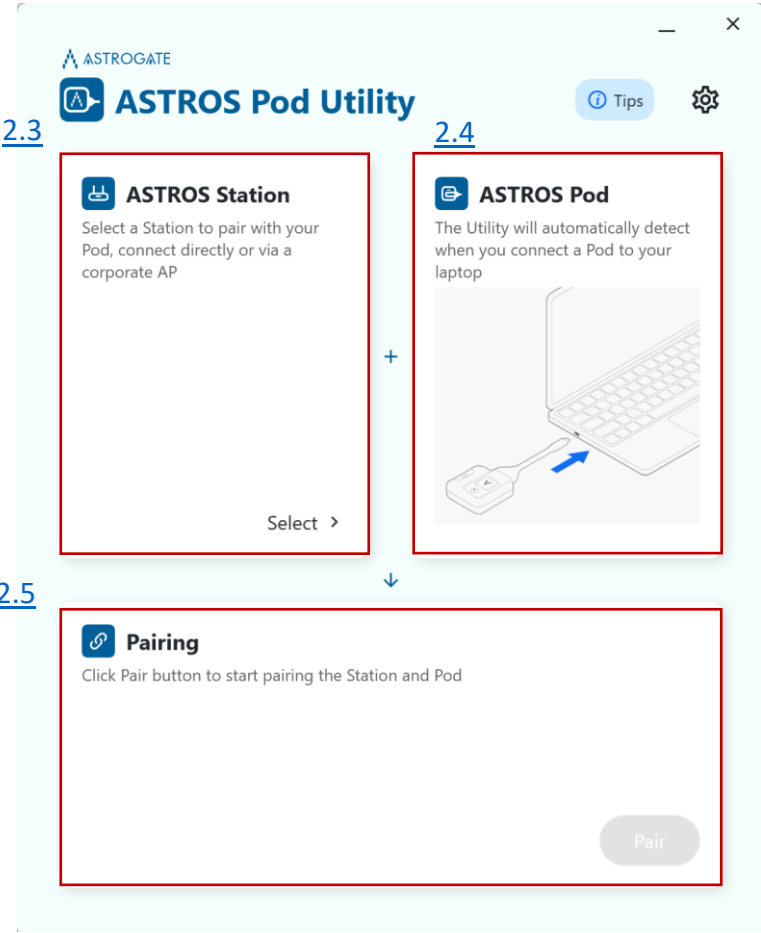

2.3 Pair to ASTROS station

How to pair

We provide 2 methods to pair your POD to ASTROS station.

Auto Detect:

You can use auto detect to pair your POD to ASTROS station through station AP.

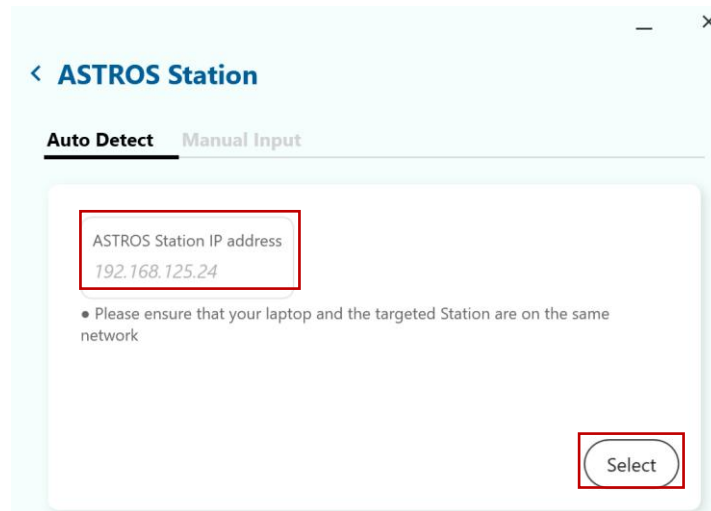
The screenshot shows a web interface for pairing a POD to an ASTROS station. At the top, there's a header with a back arrow and the text "ASTROS Station". Below this, there are two tabs: "Auto Detect" (which is selected and underlined) and "Manual Input". The main content area is a light gray box. Inside, there's a label "ASTROS Station IP address" followed by the text "192.168.125.24". Below this, there's a bullet point that says "Please ensure that your laptop and the targeted Station are on the same network". At the bottom right of the box, there is a button labeled "Select". Red rectangular boxes are drawn around the IP address text and the "Select" button in the original image.

1. Please make sure your laptop and station are under the same network first.
2. Insert your ASTROS station IP address → Click Select

Manual Input:

With this method, you can pair the Pod to other wireless access points not only limit to the station.

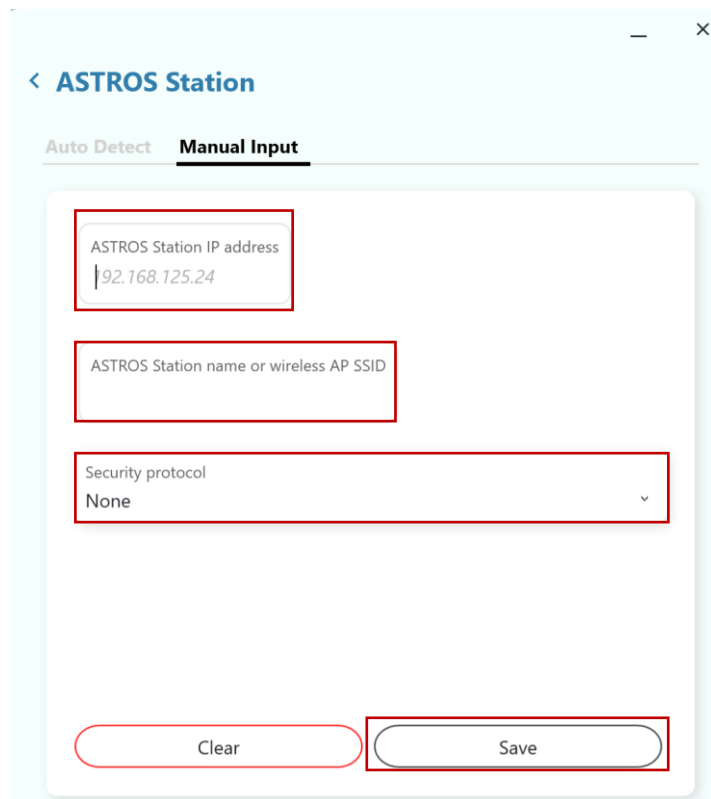

The screenshot shows a configuration window titled "ASTROS Station" with a back arrow and a close button. It has two tabs: "Auto Detect" and "Manual Input", with the latter being selected. The form contains three input fields, each highlighted with a red rectangle: the first is "ASTROS Station IP address" with the value "92.168.125.24"; the second is "ASTROS Station name or wireless AP SSID" which is empty; and the third is a dropdown menu for "Security protocol" currently set to "None". At the bottom, there are two buttons: "Clear" and "Save", both also highlighted with red rectangles.

1. Insert ASTROS station IP address.
To make sure you connect to the correct ASTROS station.
2. Insert ASTROS station name (Using station's AP) or insert other wireless AP SSID under the same LAN as station (Using other AP).
3. If your AP has password, please select the Security Protocol to WPA2
4. Click "Save" to keep the settings.

2.4 Check ASTROS POD details

In this page, you can find:

Device details

<

ASTROS Pod

—

×

Device

Model name

AP2-12

Serial number(SN)

AP212WW242200083

MAC address

70:f7:54:a3:f0:02

Version

Current Version

1.1.0.178

Check for OTA update

Manual Update

Select firmware file ('.asp' format)

Browse

Upgrade

Read all release notes

↗

FW Update

Version

Current Version

1.1.0.178

Check for OTA update

Firmware version is up to date

Manual Update

Select firmware file ('.asp' format)

Browse

Upgrade

Current version	Display the current POD FW version
Check for OTA update	Click here to check if you are using the latest FW version. It will process OTA update if you are using the older version.
Manual Update	Click here if you want to update your FW to a specific version. <i>* Please note that the FW cannot be downgraded.</i>

2.5 Click and pair

Simply click “Pair” to pair your POD to the designated ASTROS station.

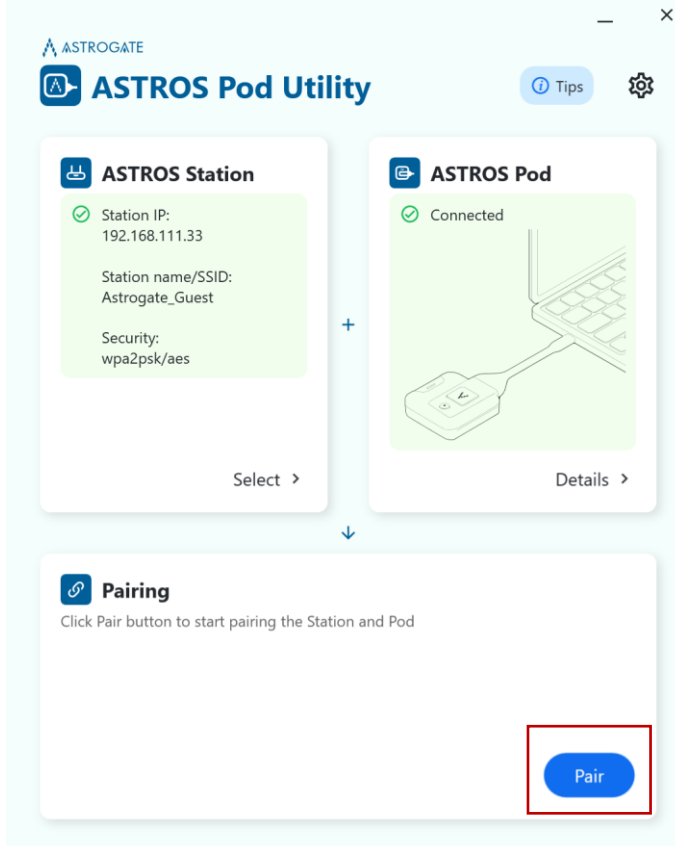

You will then see the pairing process is on-going.

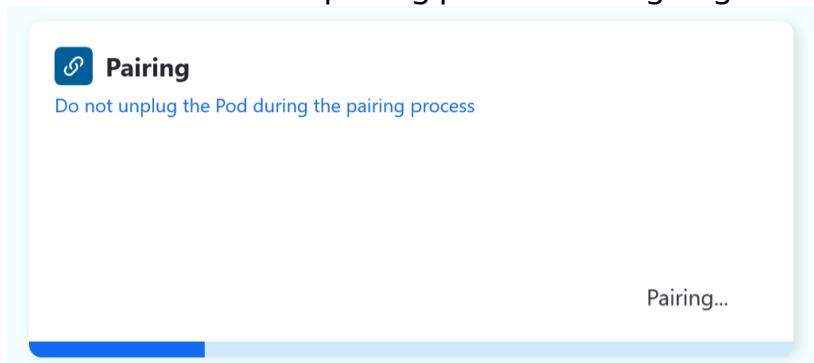

And then paired.



3 POD Utility Software settings & info

Click the settings icon on the top right.

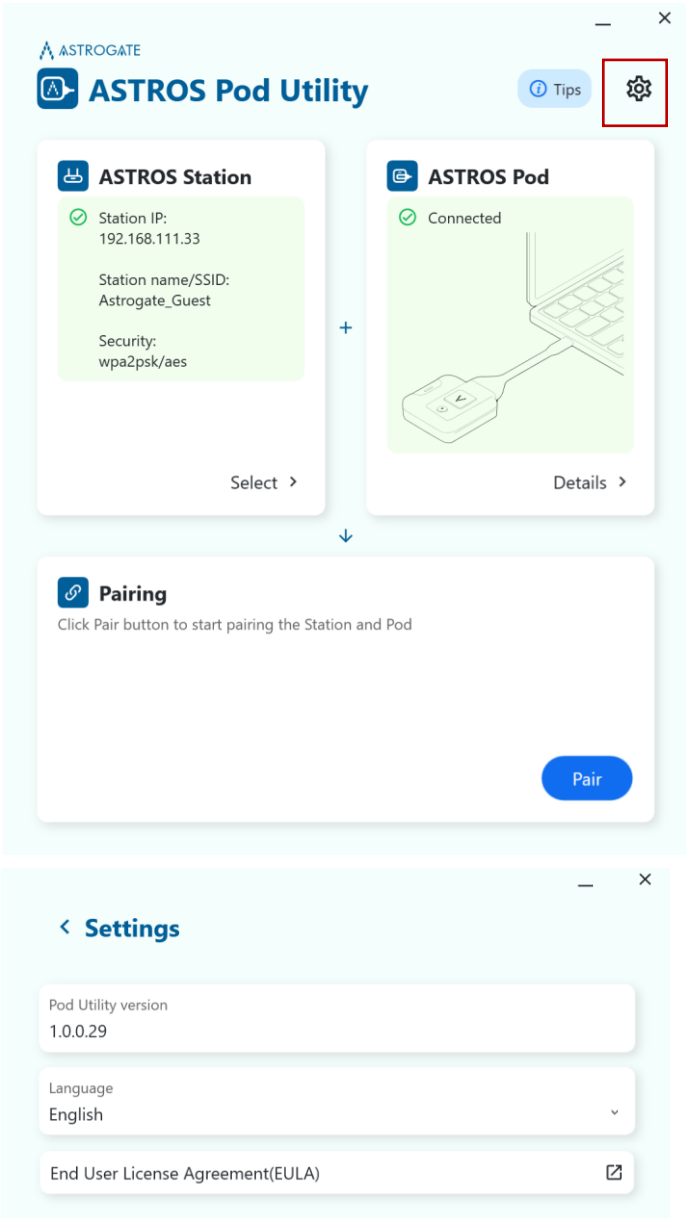

POD Utility version	Display the current POD Utility SW version.
Language	You can select the software language here.
End User License Agreement (EULA)	End User License Agreement